

Track rollers with Gothic arch groove – SG Series

The function of series SG rollers is same as the series LFR rollers. But they are mainly used in the flat track and in the condition required compact structure. After rollers are installed to the slider, the shaft will be not or seldom over the roller's side planes.

Linear Motion Guide Roller Bearing SG Series

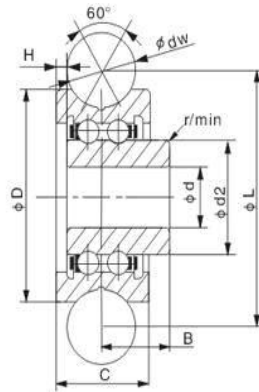

Motion(shanghai)Industrial Development Co.,Ltd

Part No.	Dimensions (mm)								Load Ratings			Weight
	dw	d	D	C	B	L	d2	H	Cw (KN)	Cow (KN)	Frperm (KN)	≈(g)
SG15	6	5	17	8	5.75	20.46	8.6	1	1.27	0.82	1.3	8
SG15-10	10	5	17	8	5.75	25.5	8.6	1	1.27	0.82	1.3	9
SG20	8	6	24	11	7.25	28.62	11.1	1.2	3.4	1.7	1.3	25
SG25	10	8	30	14	8.5	35.77	13	1.5	3.67	2.28	1.3	49
SG35	12	12	42	19	12.5	48.93	18	1.5	8.5	5.1	5.1	136
SG15N	6	5	17	8	5.75	20.46	8.6	0.5	1.27	0.82	1.3	8
SG20N	8	6	24	11	7.25	28.62	11.1	0.7	3.4	1.7	1.3	25
SG25N	10	8	30	14	8.5	35.77	13	1	3.67	2.28	1.3	49
SG35N	12	12	42	19	12.5	48.93	18	1	8.5	5.1	5.1	136

www.motnbearing.com