

Pillow block bearings are one of the most popular bearings both at home and abroad.  
 Application of stainless steel pillow block bearing:  
 -Stainless steel pillow block bearing is widely used in food devices and medical devices, etc.

Stainless steel pillow block: SUC200 Series

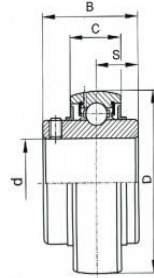

Motion(shanghai)Industrial Development Co.,Ltd

Bearing No.	Bore Dia		D	Bi	Be	r	N	M	G	ds	T	Basic Load Rating(KN)	Basic Static Rating(KN)	Weight(Kg)
	in	mm												
SUC201S		12	40	27.4	15	1	11.5	15.9	4.5	M5*0.8	3.5	7.65	3.6	0.12
SUC201-8S	1/2	12	40	27.4	15	1	11.5	15.9	4.5	M5*0.8	3.5	7.65	3.6	0.12
SUC202S		15	40	27.4	15	1	11.5	15.9	4.5	M5*0.8	3.5	7.65	3.6	0.11
SUC202-10S	5/8	15	40	27.4	15	1	11.5	15.9	4.5	M5*0.8	3.5	7.65	3.6	0.11
SUC203S		17	40	27.4	15	1	11.5	15.9	4.5	M5*0.8	3.5	7.65	3.6	0.1
SUC203-11S	11/16	17	40	27.4	15	1	11.5	15.9	4.5	M5*0.8	3.5	7.65	3.6	0.1
SUC201		12	47	31	17	1	12.7	18.3	4.7	M6*0.75	4	10.37	5.08	0.21
SUC201-8	1/2	12	47	31	17	1	12.7	18.3	4.7	M6*0.75	4	10.37	5.08	0.2
SUC202		15	47	31	17	1	12.7	18.3	4.7	M6*0.75	4	10.37	5.08	0.19
SUC202-10	5/8	15	47	31	17	1	12.7	18.3	4.7	M6*0.75	4	10.37	5.08	0.19
SUC203		17	47	31	17	1	12.7	18.3	4.7	M6*0.75	4	10.37	5.08	0.18
SUC203-11	11/16	17	47	31	17	1	12.7	18.3	4.7	M6*0.75	4	10.37	5.08	0.18
SUC204		20	47	31	17	1	12.7	18.3	4.7	M6*0.75	4	10.37	5.08	0.16
SUC204-12	3/4	20	47	31	17	1	12.7	18.3	4.7	M6*0.75	4	10.37	5.08	0.16
SUC205		25	52	34.1	17	1.5	14.3	19.8	5	M6*0.75	4.2	11.31	6	0.19
SUC205-14	7/8	25	52	34.1	17	1.5	14.3	19.8	5	M6*0.75	4.2	11.31	6	0.22
SUC205-15	15/16	25	52	34.1	17	1.5	14.3	19.8	5	M6*0.75	4.2	11.31	6	0.2
SUC205-16	1	25	52	34.1	17	1.5	14.3	19.8	5	M6*0.75	5	15.81	6	0.19
SUC206		30	62	38.1	19	1.5	15.9	19.8	5	M6*0.75	5	15.81	8.64	0.31
SUC206-17	1-1/16	30	62	38.1	19	1.5	15.9	19.8	5	M6*0.75	5	15.81	8.64	0.36
SUC206-18	1-1/8	30	62	38.1	19	1.5	15.9	19.8	5	M6*0.75	5	15.81	8.64	0.34
SUC206-19	1-3/16	30	62	38.1	19	1.5	15.9	19.8	5	M6*0.75	5	15.81	8.64	0.32
SUC206-20	1-1/4	30	62	38.1	19	1.5	15.9	19.8	5	M6*0.75	5	15.81	8.64	0.31
SUC207		35	72	42.9	20	2	17.5	25.4	6	M8*1	5.7	20.83	11.68	0.46
SUC207-20	1-1/4	35	72	42.9	20	2	17.5	25.4	6	M8*1	5.7	20.83	11.68	0.52
SUC207-21	1-5/16	35	72	42.9	20	2	17.5	25.4	6	M8*1	5.7	20.83	11.68	0.5
SUC207-22	1-3/8	35	72	42.9	20	2	17.5	25.4	6	M8*1	5.7	20.83	11.68	0.48
SUC207-23	1-7/16	35	72	42.9	20	2	17.5	25.4	6	M8*1	5.7	20.83	11.68	0.46
SUC208		40	80	49.2	21	2	19	30.2	8	M8*1	6.3	23.55	13.6	0.63
SUC208-24	1-1/2	40	80	49.2	21	2	19	30.2	8	M8*1	6.3	23.55	13.6	0.68
SUC208-25	1-9/16	40	80	49.2	21	2	19	30.2	8	M8*1	6.3	23.55	13.6	0.64
SUC209		45	85	49.2	22	2	19	30.2	8	M8*1	6.3	26.35	15.6	0.7
SUC209-26	1-5/8	45	85	49.2	22	2	19	30.2	8	M8*1	6.3	26.35	15.6	0.78
SUC209-27	1-11/16	45	85	49.2	22	2	19	30.2	8	M8*1	6.3	26.35	15.6	0.74
SUC209-28	1-3/4	45	85	49.2	22	2	19	30.2	8	M8*1	6.3	26.35	15.6	0.7
SUC210		50	90	51.6	24	2	19	32.6	10	M10*1.25	6.6	28.48	18	0.78
SUC210-29	1-13/16	50	90	51.6	24	2	19	32.6	10	M10*1.25	6.6	28.48	18	0.89
SUC210-30	1-7/8	50	90	51.6	24	2	19	32.6	10	M10*1.25	6.6	28.48	18	0.85
SUC210-31	1-15/16	50	90	51.6	24	2	19	32.6	10	M10*1.25	6.6	28.48	18	0.8
SUC210-32	2	50	90	51.6	24	2	19	32.6	10	M10*1.25	6.6	28.48	18	0.78
SUC211		55	100	55.6	25	2.5	22.2	33.4	10	M10*1.25	7	35.28	22.4	1.07
SUC211-32	2	55	100	55.6	25	2.5	22.2	33.4	10	M10*1.25	7	35.28	22.4	1.22
SUC211-33	2-1/16	55	100	55.6	25	2.5	22.2	33.4	10	M10*1.25	7	35.28	22.4	1.18
SUC211-34	2-1/8	55	100	55.6	25	2.5	22.2	33.4	10	M10*1.25	7	35.28	22.4	1.1
SUC211-35	2-3/16	55	100	55.6	25	2.5	22.2	33.4	10	M10*1.25	7	35.28	22.4	1.05
SUC212		60	110	65.1	28	2.5	25.4	39.7	10	M10*1.25	7.6	42.5	26.34	1.52
SUC212-36	2-1/4	60	110	65.1	28	2.5	25.4	39.7	10	M10*1.25	7.6	42.5	26.34	1.65
SUC212-37	2-5/16	60	110	65.1	28	2.5	25.4	39.7	10	M10*1.25	7.6	42.5	26.34	1.55
SUC212-38	2-3/8	60	110	65.1	28	2.5	25.4	39.7	10	M10*1.25	7.6	42.5	26.34	1.49
SUC212-39	2-7/16	60	110	65.1	28	2.5	25.4	39.7	10	M10*1.25	7.6	42.5	26.34	1.42
SUC213		65	120	65.1	28	2.5	25.4	39.7	10	M10*1.25	8.9	46.5	30.4	1.8
SUC213-40	2-1/2	65	120	65.1	28	2.5	25.4	39.7	10	M10*1.25	8.9	46.5	30.4	0.88
SUC213-40	2-9/16	65	120	65.1	28	2.5	25.4	39.7	10	M10*1.25	8.9	46.5	30.4	1.8
SUC214		70	125	74.6	30	2.5	30.2	44.4	12	M12*1.5	8.9	50.15	33.6	2.06
SUC214-42	2-5/8	70	125	74.6	30	2.5	30.2	44.4	12	M12*1.5	8.9	50.15	33.6	2.1
SUC214-43	2-11/16	70	125	74.6	30	2.5	30.2	44.4	12	M12*1.5	8.9	50.15	33.6	2.08
SUC214-44	2-3/4	70	125	74.6	30	2.5	30.2	44.4	12	M12*1.5	8.9	50.15	33.6	2.07
SUC215		75	130	77.8	32	2.5	33.3	44.5	12	M12*1.5	8.9	53.55	37.6	2.19
SUC215-45	2-13/16	75	130	77.8	32	2.5	33.3	44.5	12	M12*1.5	8.9	53.55	37.6	2.41
SUC215-46	2-7/8	75	130	77.8	32	2.5	33.3	44.5	12	M12*1.5	8.9	53.55	37.6	2.31

SUC215-47	2-15/16	75	130	77.8	32	2.5	33.3	44.5	12	M12*1.5	8.9	53.55	37.6	2.21
SUC215-48	3	75	130	77.8	32	2.5	33.3	44.5	12	M12*1.5	8.9	53.55	37.6	2.11
SUC216		80	140	82.6	33	3	33.3	49.3	14	M12*1.5	9.6	58.65	40.8	2.82
SUC216-50	3-1/8	80	140	82.6	33	3	33.3	49.3	14	M12*1.5	9.6	58.65	40.8	2.9
SUC217		85	150	85.7	35	3	34.1	51.6	14	M12*1.5	10	68	48.8	3.46
SUC217-52	3-1/4	85	150	85.7	35	3	34.1	51.6	14	M12*1.5	10	68	48.8	3.56
SUC218		90	160	96	37	3	39.7	56.3	15	M12*1.5	11	77.52	54.56	4.53
SUC218-56	3-1/2	90	160	96	37	3	39.7	56.3	15	M12*1.5	11	77.52	54.56	4.62

www.motnbearing.com