

Air Conditioner Bearing It consists of two sets of bearing assemblies.
 With good assembly performance, can be omitted clearance adjustment, light weight, compact structure, large load capacity, can be pre-loaded to grease sealed bearings, hub seals and maintenance omitted from the external wheel, etc.
 Wide range of applications.
 Easy to use, It does not require cleaning.

Air Conditioner Bearing

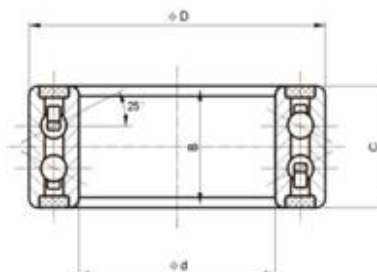

Motion(shanghai)Industrial Development Co.,Ltd

| Bearing No. | Dimension(mm) | | | | Weight Kg | Relative No. | | |
|---------------|---------------|----|------|------|--------------|----------------|-----|-----------------|
| | d | D | B | C | | NACHI | FAG | KOYO |
| PC17400012 | 17 | 40 | 12 | 12 | 0.065 | | | |
| PC256200206 | 25 | 62 | 20.6 | 20.6 | | | | |
| PC25500010 | 25 | 50 | 10 | 10 | 0.08 | | | |
| PC30450023 | 30 | 45 | 23 | 23 | 0.105 | | | |
| PC30460018/16 | 30 | 46 | 18 | 16 | 0.13 | | | |
| PC30470012 | 30 | 47 | 12 | 12 | 0.08 | | | |
| PC30470018 | 30 | 47 | 18 | 18 | 0.13 | 30BD219 | | 83A693-2RD30GDC |
| PC30470020 | 30 | 47 | 20 | 20 | 0.106 | | | |
| PC30470022 | 30 | 47 | 22 | 22 | 0.11 | 30BG04S13G | | |
| PC30500020 | 30 | 50 | 20 | 20 | 0.13 | | | |
| PC30520020 | 30 | 52 | 20 | 20 | 0.14 | | | |
| PC30520022 | 30 | 52 | 22 | 22 | 0.15 | 30BGS10G | | DAC3052-3RR9X |
| PC30550023 | 30 | 55 | 23 | 23 | 0.16 | 30BG05S5DS | | |
| PC30550026 | 30 | 55 | 26 | 26 | 0.18 | | | |
| PC30620016/24 | 30 | 62 | 24 | 16 | 0.237 | | | |
| PC30620027 | 30 | 62 | 27 | 27 | 0.34 | 30BGS1-2NSL | | |
| PC32470018 | 32 | 47 | 18 | 18 | 0.13 | | | |
| PC32520020/18 | 32 | 52 | 20 | 18 | 0.16 | | | |
| PC32550023 | 32 | 55 | 23 | 23 | 0.16 | 32BG05S1 | | |
| PC35500020 | 35 | 50 | 20 | 20 | 0.15 | 35BGS06S7G-2DL | | |
| PC35520012 | 35 | 52 | 12 | 12 | 0.069 | | | |
| PC35520020 | 35 | 52 | 20 | 20 | 0.17 | | | |
| PC35520022 | 35 | 52 | 22 | 22 | 0.12 | 35BD5222 | | |
| PC35520023 | 35 | 52 | 23 | 23 | 0.12 | | | |
| PC35550020 | 35 | 55 | 20 | 20 | 0.15 | 35BD219 | | |
| PC35620024 | 35 | 62 | 24 | 24 | 0.278 | | | |
| PC356200255 | 35 | 62 | 25.5 | 25.5 | 0.277 | | | |
| PC35620028 | 35 | 62 | 28 | 28 | 0.294 | | | |
| PC38540017 | 38 | 54 | 17 | 17 | 0.14 | 38BG05S6DST2 | | |
| PC40550024 | 40 | 55 | 24 | 24 | 0.17 | | | |
| PC40570024 | 40 | 57 | 24 | 24 | 0.18 | DF0882LR | | |
| PC40570024/20 | 40 | 57 | 24 | 20 | 0.18 | | | |
| PC40620020/15 | 40 | 62 | 20 | 15 | 0.18 | | | |

| | | | | | | | | |
|----------------|----|----|-------|-------|-------|-------------|---------|--|
| PC40620024/206 | 40 | 62 | 24 | 20.6 | 0.18 | 40BD49AWDU5 | | |
| PC406200206 | 40 | 62 | 20.62 | 20.62 | 0.18 | 40BD49V | 712019 | |
| PC40620024 | 40 | 62 | 24 | 24 | 0.19 | 40BD219 | | |
| PC40640024 | 40 | 64 | 24 | 24 | 0.21 | | 5908-64 | |
| PC40660024 | 40 | 66 | 24 | 24 | 0.23 | 40BGS39DL | | |
| PC40680030 | 40 | 68 | 30 | 30 | 0.365 | | | |
| PC45750032 | 45 | 75 | 32 | 32 | 0.5 | | | |
| PC50720020 | 50 | 72 | 20 | 20 | 0.33 | 50BG07S1 | | |

www.motnbearing.com