

The clutch release bearing—commonly referred to as the "throw out" bearing—pushes on the pressure plate to disengage the clutch.

Symptoms of Wear or Failure

Abnormal noise when clutch pedal is depressed

Related Repair Advice

Some newer vehicles combine the clutch release bearing and slave cylinder into a single unit. In this case, it is necessary to remove the transmission to replace the slave cylinder.

The release bearing should be replaced whenever the clutch assembly is replaced

Incorrect linkage/cable adjustment or "riding" the clutch (resting one's foot on the clutch pedal, not allowing the clutch to release completely) can cause premature release bearing failure

Clutch Bearing

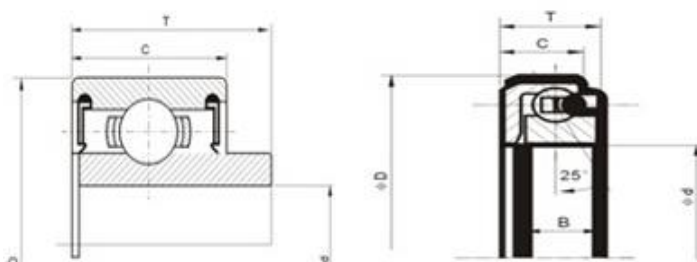

Motion(shanghai)Industrial Development Co.,Ltd

Bearing No.	Dimension(mm)				Weight
	d	D	T	C	Kg
B2030	12	57.6	15.6	32	0.22
8016	16	35	12.7	11	0.05
B2046	23.6	50	40	30.8	0.2
33263	25.5	50.8	15.875	14.288	0.16
6006D	30	59	13	24	0.16
68432	30.7	49	13	11	0.05
68899	30.85	49	17	12	0.05
76-520806	31	55	18.5	13	0.07
616054	31	55	20	13	0.08
B542	33.34	44.45	7.14	6.35	0.08
615885	37	62	20.5	14	0.13
40609	40	60	9	9	0.064
L6240F	40.55	62	17.2	12	0.15
VKC2169	33	39.5	24		0.36

VKC3577	35	55	24		0.46
VKC3507	36	54	27		0.48
VKC3519	40	69.8	18		0.3
VKC3540	55	68	22		0.3
B633254	35	58.5	25	30	0.16
35BCV01Z	35	55	11	7.32	5.32
FCR54/48-4/2E	36	71	39		0.45
50TKA3805	38.2	56	16.8	46	0.36
38084	38.1	67	14.5	16	0.3
40TRK39-4	40	64	16		0.28
40TRK-1	40	75	19		0.34
40TNK-1	41	70	18		0.3
360708K3	40	66	9	17	0.2
40TRK30W2SB	40	67	20		0.31
RCT-4075-1S	40	74.7	17	19	0.28
63440	47	72	17.1	12	0.2
52TRBC09-7SB	52.4	92	26		0.54
CT1310	63.5	103.6	20.75	15.7	0.619

www.motnbearing.com